

## EPV 250 PUMP



### Applications:

- Vortex type pump is used for pumping liquids which contains metal chips,
- Cutting, turning, milling, boring, grinding and similar applications of the machine tools,
- Filtration systems,
- Circulation systems. EPV Pumps are used for pumping of cutting / cooling fluids.

### Fluid Specifications:

- Coolants,
- Cutting oils,
- Grinding oils,
- Water,
- Chip contains liquids (max. 12mm)
- Fluid temperature 0...80 °C
- Kinematic viscosity 1...45 mm<sup>2</sup>/s

### Materials:

Pump body	: Cast iron - DIN GG 25
Volute	: Cast iron - DIN GG 25
Impeller	: Investment casting steel - AISI 4140 (DIN 42CrMo4)
Pump shaft	: Engineering steel - AISI 1040 (DIN C35)
Electric motor	: 3 phase induction motor 2 pole, 2900 rpm Protection degree IP 55

### DIMENSIONS & NOMINAL VALUES

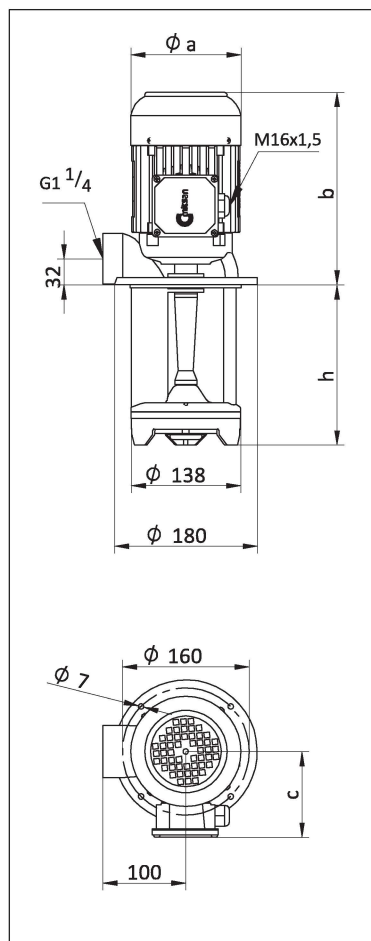

TYPE	Depth of immersion h (mm)	mm			Weight kg	Power kW	Voltage V(Δ/Y)	Frequency Hz	Rated current A	Speed rpm
		a	b	c						
EPV 250/210	210	138	242	111	16.4	0.55	230/400	50	2.25/1.3	2780
EPV 250/280	280				17.6					
EPV 250/360	360				17.9					
<b>EPV 250/450</b>	<b>450</b>				<b>19.6</b>					
EPV 250/560	560				20.6					

\* Pump dimensions according to EN 12157.  
 \*\* The performance curves are based on 1 mm<sup>2</sup>/s (cSt) kinematic viscosity values and 997 kg/m<sup>3</sup> density  
 \*\*\* Curve tolerance according to ISO 9906:2012 Grade 3B .

Performance Curve

